

NOTES

1. Do not scale from this drawing.
2. This drawing is for illustrative purposes only and not for construction.
3. This drawing is to be read and printed in colour.
4. Ordnance Survey data based on Emapsite 19.02.2018.
5. Exact location of River Alver and other watercourses to be confirmed by internal topographical survey
6. Land within visibility splays are not to be adopted by the LHA, but instead covered by a restricted covenant/easement
7. Visibility splays calculated in accordance with TG3 based on 85th percentile speed reading. Excluding 31st January & 1st February 2019

KEY

- SITE BOUNDARY
- 2.4m x 55m VEHICULAR VISIBILITY SPLAY (NORTH)
- 2.4m x 74m VEHICULAR VISIBILITY SPLAY (SOUTH)
- 1.5m x 55m PEDESTRIAN VISIBILITY SPLAY (NORTH)
- 1.5m x 74m PEDESTRIAN VISIBILITY SPLAY (SOUTH)
- MAIN RIVER WATERCOURSE RIVER ALVER
- CARRIAGEWAY
- FOOTWAYS

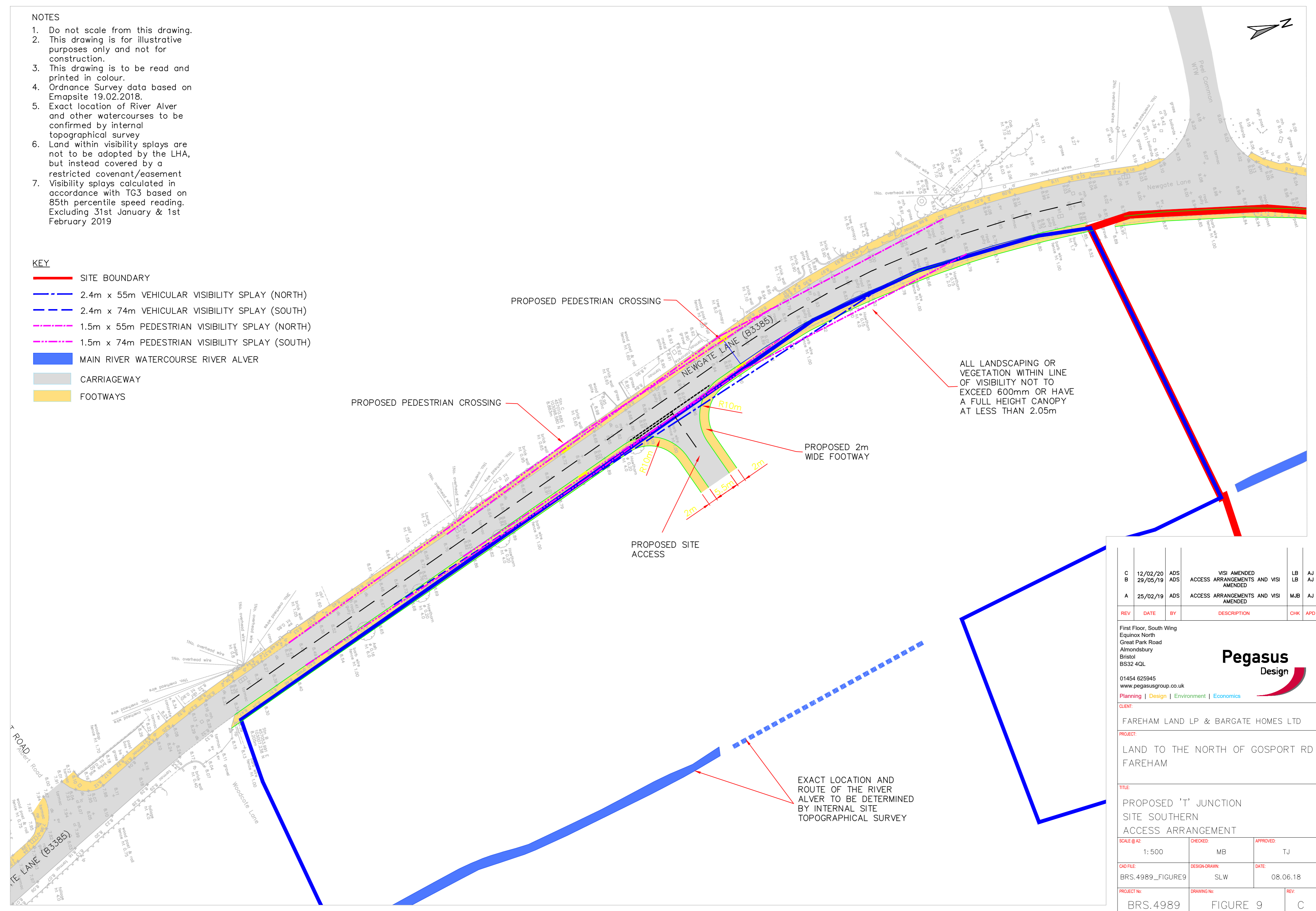

ALL LANDSCAPING OR VEGETATION WITHIN LINE OF VISIBILITY NOT TO EXCEED 600mm OR HAVE A FULL HEIGHT CANOPY AT LESS THAN 2.05m

EXACT LOCATION AND ROUTE OF THE RIVER ALVER TO BE DETERMINED BY INTERNAL SITE TOPOGRAPHICAL SURVEY

REV	DATE	BY	DESCRIPTION	CHK	APD
C	12/02/20	ADS	VISI AMENDED	LB	AJ
B	29/05/19	ADS	ACCESS ARRANGEMENTS AND VISI AMENDED	LB	AJ
A	25/02/19	ADS	ACCESS ARRANGEMENTS AND VISI AMENDED	MJB	AJ

First Floor, South Wing
Equinox North
Great Park Road
Almondsbury
Bristol
BS32 4QL

Pegasus Design

01454 625945
www.pegasusgroup.co.uk
Planning | Design | Environment | Economics

CLIENT:
FAREHAM LAND LP & BARGATE HOMES LTD

PROJECT:
LAND TO THE NORTH OF GOSPORT RD FAREHAM

TITLE:
PROPOSED 'T' JUNCTION
SITE SOUTHERN
ACCESS ARRANGEMENT

SCALE @ A2: 1: 500	CHECKED: MB	APPROVED: TJ
CAD FILE: BRS.4989_FIGURE9	DESIGN-DRAWN: SLW	DATE: 08.06.18
PROJECT No: BRS.4989	DRAWING No: FIGURE 9	REV: C